



TIRE PATCH
NYLON &
RADIAL



TUBE
PATCHES
AND REPAIRS



TIRE AND
TUBE REPAIR
(PUNCTURE)
MATERIALS

TOOLS
(TIRE & TUBE
REPAIRS)

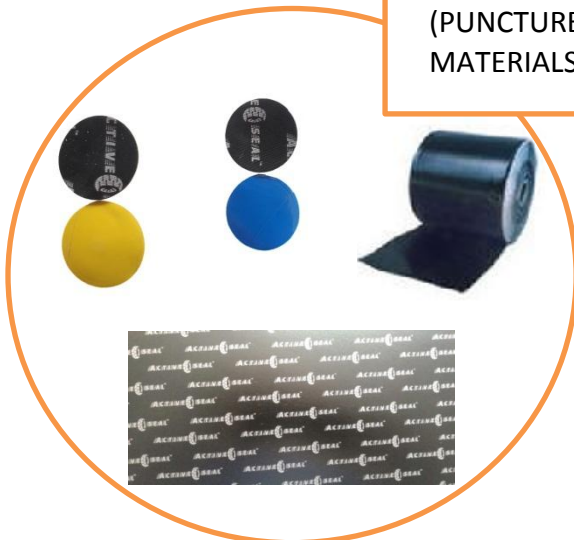

Optimus Enterprise Pvt. Ltd.

808, Synergy Tower, Nr Vodafone house, Corporate Road, Prahlad Nagar
Ahmedabad - 380015

Cell: +91 9638808081, +91 8000718800

Web : www.optimusgroup.in , Email : oepl.office@gmail.com

ABOUT OPTIMUS GROUP



Established in 2019, previously known as Optimus Auto Industries, started our first step with the idea to become popular name in Tire and Tube Repairs. Today we are proudly having around 100 and increasing dealers network across India and abroad. Supplying quality product is the key of strong business relation with customers. We started our brand **Active Seal** with the vision of popularity from the whole hierarchy of system like end users (repair personnel), distributors and dealers.

Optimus Group has experienced and knowledgeable team members who are dedicated to maintain quality in each of our products. Our perfect internal quality inspection insures that only up to the mark product goes to packing. Product with little imperfection is rejected before packing.

With continuous studying the market gives us strength and inspiration to update our products time to time. We always insist to upgrade ourselves with new technologies coming in Tires and Tubes industry.

CATALOG INFORMATION

PAGE 3 – BIAS PLY TYRE PATCHES

PAGE 4 – BIAS PLY REPAIR CHART

PAGE 5 – OTR TYRE PATCHES

PAGE 6 – RADIAL REPAIR CHART

PAGE 7 – RADIAL TIRE PATCHES

PAGE 8 – 2 WAY TUBE REPAIRS



BIAS PLY TYRE PATCHES

Active Seal Bias ply tire patches can be used to repair crown, sidewall and shoulder injuries in passenger car, tractor, truck and earthmover bias ply tires.

Active Seal bias ply can be used in both tube type tire and tubeless tire for reinforcement and section repair. Fabric construction designed to match cross ply tire construction. It is developed with special rubber compound and nylon fibers.

Active Seal Chemical vulcanizing fluid should be used for best results. It can be cured chemically or any retread system (heat cure).

Please refer standard injury chart for selection of proper patch.



Active Seal BP Patch details

Code	Description	Sizes		Ply Rating	Box Quantity
		(Inches)	(mm)		
OE301	BP 1	3" x 3"	75 x 75	1	20
OE302	BP 2	3½" x 3½"	90 x 90	2	15
OE303	BP 3	4¼" x 4¼"	105 x 105	2	10
OE304	BP 4	5" x 5"	125 x 125	4	10
OE305	BP 5	6¼" x 6¼"	155 x 155	4	10
OE306	BP 6	9" x 9"	230 x 230	6	10
OE307	BP 7	10½" x 10½"	270 x 270	6	10
OE308	BP 8	12" x 12"	305 x 305	6	05
OE309	BP 9	14½" x 14½"	365 x 365	8	03
OE310	BP 10	15" x 15"	380 x 380	8	03

BIAS PLY REPAIR CHART

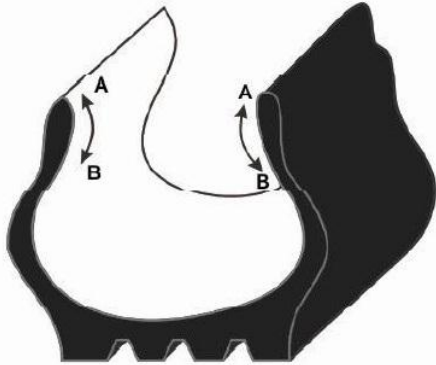

A-B NON REPAIRABLE AREA

7.00 – 8.75	3"	75 MM
9.00 – 14.00	4"	100 MM
16.00 – 18.00	5"	125 MM
21.00 – 27.00	6"	150 MM

TRACTOR A-B NON REPAIRABLE AREA

14.9 – 20.8	4"	100 MM
23.1 – LARGER	5"	125 MM

ABOVE DIMENSIONS ARE GUIDELINE ONLY

SIZE OF INJURY



PLY RATINGS	MM	3	6	10	13	20	25	40	50	65	75	100	115
	INCH	1/8"	1/4"	3/8"	1/2"	3/4"	1"	1 1/2"	2	2 1/2"	3"	4"	4 1/2"
4	BP 0	BP 0	BP 1	BP 2	BP 3	BP 3	BP 4	BP 5					
6-8	BP 0	BP 0	BP 1	BP 2	BP 3	BP 3	BP 4	BP 5	BP 6				
10-12	BP 0	BP 0	BP 2	BP 3	BP 3	BP 4	BP 4	BP 5	BP 6				
14-16	BP 0	BP 1	BP 2	BP 3	BP 3	BP 4	BP 5	BP 6	BP 6	BP 7	BP 8		
18-20	BP 0	BP 1	BP 2	BP 4	BP 4	BP 4	BP 5	BP 6	BP 6	BP 7	BP 8		
20-22	BP 0	BP 1	BP 3	BP 4	BP 4	BP 5	BP 6	BP 6	BP 7	BP 7	BP 8	BP 10	

THIS BIAS PLY REPAIR CHART IS GUIDELINE ONLY. TIRE MANUFACTURER SHOULD BE CONSULTED FOR REPAIR LIMITATIONS.

REPAIR SIZE OF INJURY – TREAD, SHOULDER AND SIDEWALL

PLY RATINGS	MM	3	10	13	25	50	75	100	125
	INCH	1/8"	3/8"	1/2"	1"	2"	3"	4"	5"
8-12	BP 0	BP 1	BP 2	BP 3	BP 4	BP 6	BP 7	BP 8	BP 8
14-18	BP 0	BP 1	BP 2	BP 4	BP 5	BP 6	BP 7	BP 8	BP 8
20-22	BP 0	BP 2	BP 3	BP 5	BP 6	BP 7	BP 8	BP 9	BP 9

TRACTOR TYRE – REPAIR CHART

PLY RATINGS	MM	3	10	13	25	50	75	100	125
	INCH	2"	3"	4"	5"	6"	7"	4"	5"
4-6	BP 0	BP 1	BP 2	BP 3	BP 4	BP 6	BP 7	BP 8	BP 8
8-12	BP 0	BP 1	BP 2	BP 4	BP 5	BP 6	BP 7	BP 8	BP 8
14-16	BP 0	BP 2	BP 3	BP 5	BP 6	BP 7	BP 8	BP 9	BP 9

OTR (Off The Road) Tyre Repairs for Bias ply Tyres

Active Seal square shaped OTR tire patches are developed with special rubber compound and strong nylon fibers.

It contains unique cross ply fabric layers to match the ply construction of Bias ply OTR tires.

It can Repair injuries up to 300 mm in OTR Tires.

SQUARE SHAPED OTR REPAIRS

Code	Description	Sizes		Ply Rating	Box Quantity
		(Inches)	(mm)		
OE400	OTR 1	3" x 3"	185 x 185	4	5
OE401	OTR 2	3½" x 3½"	215 x 215	4	5
OE402	OTR 3	4¾" x 4¾"	240 x 240	6	5
OE403	OTR 4	5" x 5"	315 x 315	6	3
OE404	OTR 5	6" x 6"	365 x 365	8	3
OE405	OTR 6	9" x 9"	395 x 395	8	3
OE406	OTR 7	10½" x 10½"	415 x 415	10	2

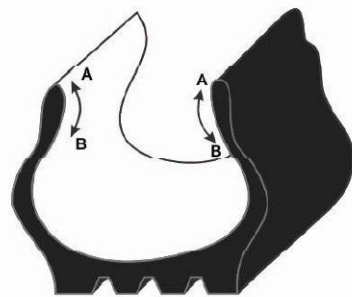

A-B NON REPAIRABLE AREA

16.00 - 18.00 (20.5 - 23.5)	5"	110 MM
26.00 - 27.00 (26.5 - 33.5)	6"	150 MM
30.00 - 33.00 (37.25 - 37.5)	7"	175 MM
36.00 And Above	8"	200 MM

ABOVE DIMENSIONS ARE GUIDELINE ONLY.

SIZE OF INJURY

	13	25	50	75	100	125	150	175	200	225	250
	1/2"	1"	2"	3"	4"	5"	6"	7"	8"	9"	10"
6-12	OTR 0	OTR 1	OTR 1	OTR 2							
14-16	OTR 0	OTR 1	OTR 2	OTR 3	OTR 3	OTR 3	OTR 4				
18-20		OTR 1	OTR 2	OTR 3	OTR 3	OTR 4	OTR 4	OTR 5			
22-24		OTR 1	OTR 2	OTR 3	OTR 4	OTR 4	OTR 5	OTR 6	OTR 6	OTR 7	
26-28		OTR 1	OTR 2	OTR 4	OTR 4	OTR 5	OTR 6	OTR 6	OTR 7	OTR 7	OTR 8
30-36		OTR 1	OTR 2	OTR 4	OTR 5	OTR 5	OTR 6	OTR 7	OTR 8	OTR 8	OTR 8
38-44		OTR 1	OTR 2	OTR 5	OTR 5	OTR 6	OTR 7	OTR 7	OTR 8	OTR 8	OTR 9
46-50		OTR 2	OTR 3	OTR 5	OTR 6	OTR 7	OTR 7	OTR 8	OTR 9	OTR 9	OTR 10
52-58		OTR 2	OTR 3	OTR 5	OTR 6	OTR 7	OTR 7	OTR 9	OTR 9	OTR 10	OTR 10
60-68		OTR 3	OTR 4	OTR 6	OTR 7	OTR 7	OTR 8	OTR 9	OTR 10	OTR 10	OTR 10

PASSENGER CAR TYRE REPAIR CHART

CROWN INJURY INCHES(mm)	SIDEWALL INJURY		PASSENGER TYRE SIZES	
	WIDTH INCHES(mm)	LENGTH INCHES(mm)	125-175	185-255
¼" (6 MM)	¼" (6mm)	1/2"(13 mm)	RDL 10	RDL 10
	¼" (6mm)	1 1/2"(40 mm)	RDL 12	RDL 12
	¼" (6mm)	2" (50 mm)	RDL 14	RDL 14
3/8"(10mm)	3/8"(10mm)	3/8"(10mm)	RDL 10	RDL 10
	3/8"(10mm)	1 1/2"(40 mm)	RDL 12	RDL 12
	3/8"(10mm)	2" (50 mm)	RDL 14	RDL 14
1/2"(13 mm)	1/2"(13 mm)	1 1/2"(40 mm)	RDL 12	RDL 12
	1/2"(13 mm)	2" (50 mm)	RDL 14	RDL 14
¾"(20 mm)	¾"(20 mm)	1 1/2"(40 mm)	RDL 12	RDL 12
	¾"(20 mm)	2" (50 mm)	RDL 14	RDL 14
1"(25 mm)	1"(25 mm)	1 1/2"(40 mm)	RDL 14	RDL 14
	1"(25 mm)	2" (50 mm)	RDL 14	RDL 22

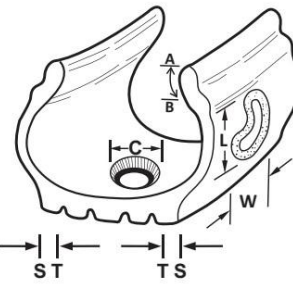

C: Crown Injury
W: Width of Injury
L: Length of Injury
T-S: Shoulder Area
T-T: Crown area

A-B NON REPAIRABLE AREA
 PASSENGER 1 ½" (40mm)
 6.50 - 7.00 2 ½" (65mm)
 7.50 - 16.00 3" (75mm)

TRUCK, LCV RADIAL TYRE REPAIR CHART

CROWN INJURY INCHES(mm)	SIDEWALL INJURY		USE RADIAL REPAIR PATCHES-RD TRUCK TYRE SIZES		
	WIDTH INCHES(mm)	LENGTH INCHES(mm)	6.00-7.50	8.25 -10.00	11.00 -14.00
			7 R - 8.5 R	9 R -11 R	12 R - 16.5 R
			215/- 235/-	235/- 285/-	295/- 425/-
(3 MM)	1 1/8"(3mm)	1 1/8"(3mm)	RDL 10	RDL 10	RDL 10
¼" (6 MM)	3/8"(10mm)	3/8"(10mm)	RDL 12	RDL 12	RDL 12
	1 Cable	1 1/2"(40 mm)	RDL 20	RDL 20	RDL 20
	1 Cable	3" (75mm)	RDL 22	RDL 22	RDL 22
	1 Cable	5" (125mm)		RDL 24	RDL 24
	1 Cable	6" (150mm)		RDL 26	RDL 26
1/2"(13 mm)			RDL 22	RDL 33	RDL 33
	2 Cable	3/4" (20mm)	RDL 20	RDL 20	RDL 22
	2 Cable	1 1/2"(40 mm)	RDL 20	RDL 22	RDL 24
	2 Cable	2 1/2"(65 mm)	RDL 22	RDL 24	RDL 26
	2 Cable	5 1/8"(130 mm)		RDL 26	RDL 26
	3/8"(10mm)	1 1/2"(40 mm)	RDL 20	RDL 26	RDL 40
	3/8"(10mm)	2 3/8"(60 mm)	RDL 22	RDL 26	RDL 40
	3/8"(10mm)	3 1/8"(80 mm)	RDL 26	RDL 26	RDL 42
¾"(20 mm)	3/8"(10mm)	5" (125mm)		RDL 26	RDL 42
			RDL 24	RDL 33	RDL 35
	½" (13MM)	1 1/2"(40 mm)	RDL 22	RDL 40	RDL 40
	½" (13MM)	2 1/2"(65 mm)	RDL 22	RDL 40	RDL 42
	½" (13MM)	4"(100MM)		RDL 42	RDL 44
	½" (13MM)	5" (125mm)		RDL 42	RDL 44
	3/4" (20mm)	1"(25MM)	RDL 22	RDL 40	RDL 42
	3/4" (20mm)	2 1/2"(65 mm)		RDL 42	RDL 44
	3/4" (20mm)	4 1/8"(110 mm)		RDL 42	RDL 44
	3/4" (20mm)	5 1/8"(130 mm)		RDL 44	RDL 44
1"(25 mm)			RDL 33	RDL 35	RDL 35
	1"(25 mm)	2" (50MM)	RDL 40	RDL 42	RDL 44
	1"(25 mm)	3" (75mm)		RDL 42	RDL 44
	1"(25 mm)	4"(100MM)		RDL 44	RDL 44
1 ¼" (32MM)				RDL 37	RDL 37
	1 ¼" (32MM)	2" (50MM)		RDL 42	RDL 44
	1 ¼" (32MM)	3 1/8"(80 mm)		RDL 44	RDL 44
	1 ¼" (32MM)	4"(100MM)		RDL 44	RDL 44
1 1/2"(40 mm)				RDL 37	RDL 37
	1 1/2"(40 mm)	2" (50MM)		RDL 44	RDL 44
	1 1/2"(40 mm)	3 1/8"(80 mm)		RDL 44	RDL 44
				RDL 46	

RADIAL TYRE PATCHES

Active Seal Radial tire repair patches are developed with engineered rubber compound and fibers. It gives permanent repair over the injury.

Active Seal Radial Patches offer great flexibility and high strength due to single direction ply and locking wedge construction. So they increase life of tire and saves cost of new tires. It can be cured chemically (cold cure) or with any retread system (heat cure).

Active Seal Patches can be used to repair crown, sidewall and shoulder injuries passenger, light truck, truck and earthmover tires.

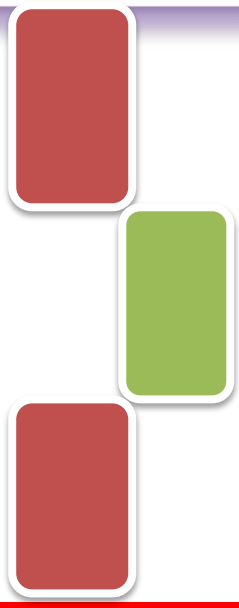

Code	Description	Sizes		Ply Rating	Box Quantity
		(Inches)	(mm)		
OE500	RDL 10	3" x 2"	75 x 50	1	20
OE501	RDL 12	4¼" x 2¼"	110 x 60	1	15
OE502	RDL 14	5¾" x 3"	145 X 75	1	10
OE503	RDL 20	5¼" x 3"	130 x 75	2	10
OE504	RDL 22	6½" x 3"	165 x 75	2	10
OE505	RDL 24	8¾" x 3"	225 x 75	2	10
OE506	RDL 26	8¾" x 3¼"	225 x 80	3	10
OE507	RDL 33*	5" x 4"	125 x 100	3	10
OE508	RDL 35*	6" x 5"	150 x 125	4	10
OE509	RDL 37*	6¾" x 5"	175 x 127	4	10
OE510	RDL 40	8" x 4"	200 x 100	3	10
OE 511	RDL 42	9¾" x 5"	250 x 125	4	10
OE 512	RDL 44	12½" x 5¼"	320 x 130	4	10
OE 513	RDL 45*	9½" x 7¾"	240 X 195	4	5
OE 514	RDL 50	19¾" x 7½"	500 X 190	5	5
OE 515	RDL 52	22½" x 9¾"	570 x 250	5	3
OE 516	RDL 56	26" x 10¼"	660 x 260	7	3
OE 517	RDL 84	11¾" x 8¾"	300 x 220	3	3

* For CROWN INJURIES ONLY.

2 WAY & BICYCLE TUBE REPAIRS

Active Seal Tube repairs are widely popular for its high strength and durability.

They are made using special chemicals used for rubber products. They are made of black cured body with self-vulcanizing cushion gum.

Active Seal cycle tube repairs are available in round shape and sheets. Sheets can be used to repair tube injury of any size.

Active Seal chemical vulcanizing fluid should be used for perfect result in tube repair.



2 WAY TUBE REPAIRS

Code	Description	Sizes		Box Quantity
		(Inches)	(mm)	
OE702	TINY ROUND	1 1/8"	29	100
OE703	MINI ROUND	1 3/8"	35	50
OE704	SMALL ROUND	1 3/4"	43	40
OE705	MEDIUM ROUND	2 1/4"	58	30
OE706	LARGE ROUND	3 1/8"	80	20
OE710	SMALL OVAL	2 1/2" x 1 1/2"	62 x 38	30
OE712	MEDIUM OVAL	4" x 2"	100 x 50	20

CYCLE TUBE REPAIRS

Code	Description	Sizes		Box Quantity
		(Inches)	(mm)	
OE715	CYCLE ROUND	1 1/8"	28	100
OE716	CYCLE ROUND	1	26	50
OE717	CYCLE SHEET	9" X 13"	228 x 330	100
OE718	CYCLE SHEET	15" X 15"	381 x 381	100

